



H 204

3" Dome H 204 High Fidelity soft dome midrange unit.

Chassis: glassfibre reinforced plastic, black.

Diaphragm: polyamide, light grey.

Mounting holes: 4 x 5 mm, equispaced on PCD 139 mm

The H 204 features very smooth response from 400 through 4000 Hz produced by a 3" dome vacuum formed from high loss polyamide. The internally located ferrite magnet results in a very efficient system provi-

ding mechanical damping of the diaphragm and producing an almost flat impedance curve. The unit includes a rear enclosure with optimal shape, volume and damping.

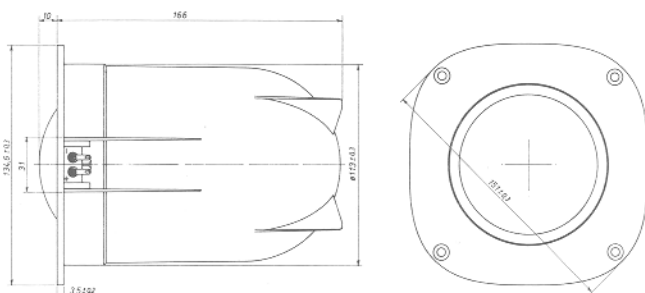

Technical data:

8 ohms

Recommended frequency range	400 - 4000	Hz	Voice coil inductance	-	mH
Nominal power (DIN 45573)	80	W 1)	Voice coil resistance	6,4	ohms
Music power (DIN 45 500)	-	W	Effective diaphragm area	55	cm ²
Characteristic sensitivity (Im, lw)	91	dB SPL	Moving mass	3,1	g
Operating power (DIN 45500)	3,2	W	Air load mass in baffle	0,5	g
Voice coil diameter	76,5	mm	Free air resonance	400	Hz
Voice coil height	3,0	mm			
Air gap height	2,0	mm			
Flux density	0,95	T			
Force factor	4,7	Wb/m			
Weight	0,65	kg			
Magnet weight	0,25	kg			

1) Crossover frequency 500 Hz, 12 dB/oct.

NOTES:

Response curves recorded in anechoic chamber (Free-Field, 4π -radiation) with 0.5 m microphone distance. The loudspeaker is mounted in a 0.6 m by 0.8 m baffle:

A Sound pressure on and off axis, and impedance:

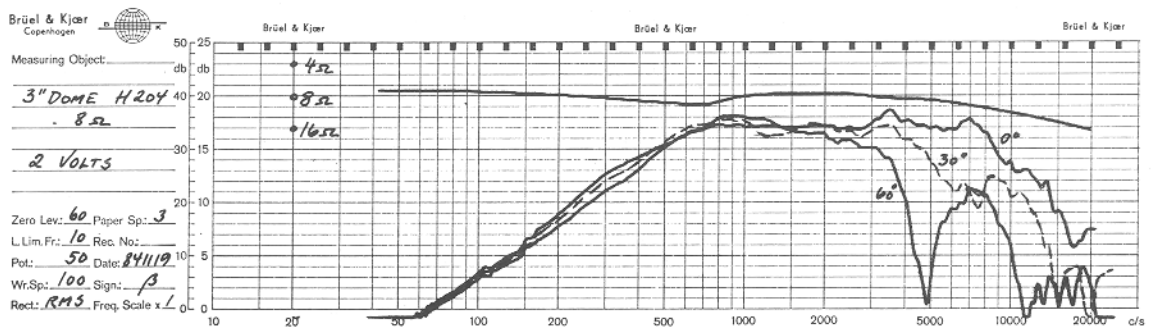

B Sound pressure and distortion on axis. The distortion components are raised by 20 dB:

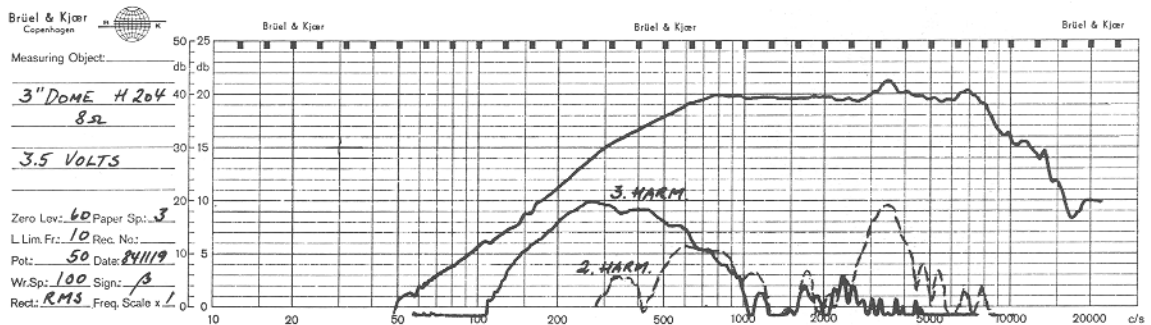

C Sound pressure response to 4 Volts step function:

Sound
pressure
0.56 Pa/div

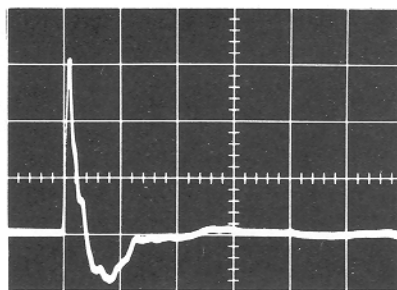

1 ms/div Time →

seas

Seas Fabrikker a.s
P.O.Box 600, Høyden, N-1501 Moss, Norway
Phone +47-32-65 811
Telex N 18419

Note: New telex no. 78419 SEAS N from June 20, 1985